

Front Patching Shelf for Optical Component Modules

TELECOM OUTSIDE PLANT

Modules are installed sequentially starting from the left side.
The module support bracket is installed (as shown) next to the last module.

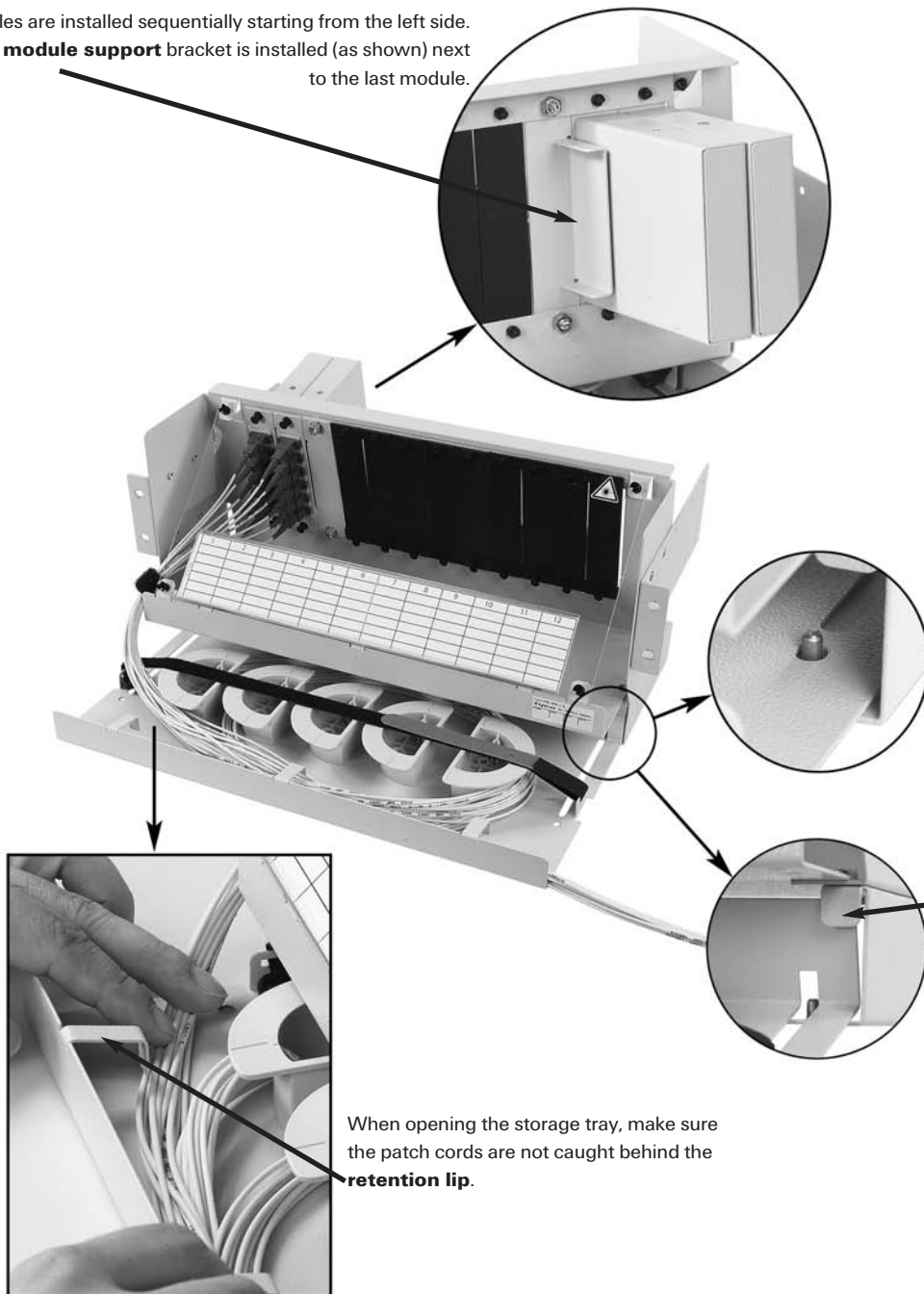

In closed position, the storage tray is secured by the pin.
To open, lift the storage tray over the pin, slide the tray open until it butts against **the tray lip**.

When opening the storage tray, make sure the patch cords are not caught behind the **retention lip**.

Tyco Electronics Raychem NV
Telecom Outside Plant
Diestsesteenweg 692
B-3010 Kessel-Lo, Belgium
Tel.: 32-16-351 011
Fax: 32-16-351 697
www.tycoelectronics.com
www.telecomosp.com

The information given herein, including drawings, illustrations and schematics which are intended for illustration purposes only, is believed to be reliable. However, Tyco Electronics makes no warranties as to its accuracy or completeness and disclaims any liability in connection with its use. Tyco Electronics' obligations shall only be as set forth in Tyco Electronics' Standard Terms and Conditions of Sale for this product and in no case will Tyco Electronics be liable for any incidental, indirect or consequential damages arising out of the sale, resale, use or misuse of the product. Users of Tyco Electronics products should make their own evaluation to determine the suitability of each such product for the specific application.