

# 1.4

## LSA-PLUS/PROFIL

## Accessories LSA-Series 2

### LSA-Number Flags, Cover Strips

Order No.	Number flags	Pack
6089 3 023-00	LSA-Number flags 1-0, grey	10 pcs
6089 3 023-01	LSA-Number flags 10-100, grey	10 pcs
6089 3 023-40	LSA-Number flags 1-10, grey	10 pcs
6089 3 023-41	LSA-Number flags 11-20, grey	10 pcs
6089 3 023-42	LSA-Number flags 21-30, grey	10 pcs
6089 3 023-43	LSA-Number flags 31-40, grey	10 pcs
6089 3 023-44	LSA-Number flags 41-50, grey	10 pcs
6089 3 023-45	LSA-Number flags 51-60, grey	10 pcs
6089 3 023-46	LSA-Number flags 61-70, grey	10 pcs
6089 3 023-47	LSA-Number flags 71-80, grey	10 pcs
6089 3 023-48	LSA-Number flags 81-90, grey	10 pcs
6089 3 023-49	LSA-Number flags 91-100, grey	10 pcs
0637 0 007-47	LSA-Number flags 10-200, grey	1 pc
0637 0 008-02	LSA-Number flags 10-400, grey	1 pc
0637 0 008-03	LSA-Number flags 10-600, grey	1 pc

For marking the modules of Series 2 and TERMINATOR.

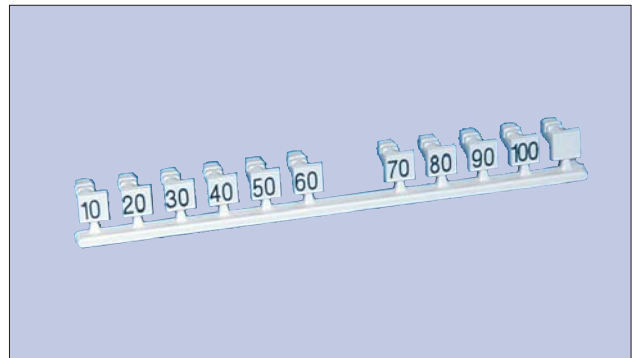
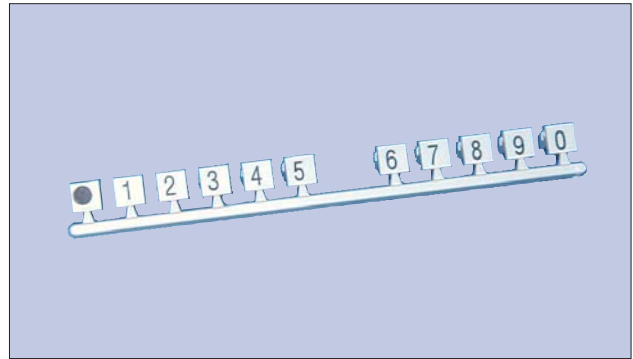

Order No.	Marking caps 2/1	Pack
6089 3 006-00	LSA-Marking cap 2/1, red	100 pcs
6089 3 006-01	LSA-Marking cap 2/1, white	100 pcs
6089 3 006-02	LSA-Marking cap 2/1, green	100 pcs
6089 3 006-03	LSA-Marking cap 2/1, yellow	100 pcs
6089 3 006-04	LSA-Marking cap 2/1, grey	100 pcs
6089 3 006-05	LSA-Marking cap 2/1, black	100 pcs
6089 3 006-06	LSA-Marking cap 2/1, brown	100 pcs
6089 3 006-07	LSA-Marking cap 2/1, blue	100 pcs

For marking important connections (1 pair) in LSA-PLUS/PROFIL modules.



### LSA-Marking Caps, Dummy- and Disconnection Plugs

Order No.	Dummy plug 2/1 with label area	Pack
6417 3 105-00	LSA-Dummy plug 2/1, BF, red	100 pcs
6417 3 105-01	LSA-Dummy plug 2/1, BF, white	100 pcs
6417 3 105-02	LSA-Dummy plug 2/1, BF, green	100 pcs
6417 3 105-03	LSA-Dummy plug 2/1, BF, yellow	100 pcs
6417 3 105-04	LSA-Dummy plug 2/1, BF, green	100 pcs
6417 3 105-05	LSA-Dummy plug 2/1, BF, black	100 pcs
6417 3 105-06	LSA-Dummy plug 2/1, BF, brown	100 pcs
6417 3 105-07	LSA-Dummy plug 2/1, BF, blue	100 pcs

With label area, for marking lines as well as preventing unwanted access to LSA-PLUS/PROFIL connection modules and to preventing disconnection in the case of disconnection modules



Order No.	Dummy plug 2/1 with extraction hook	Pack
6089 3 056-00	LSA-Dummy plug 2/1, AÖ, red	100 pcs
6089 3 056-01	LSA-Dummy plug 2/1, AÖ, white	100 pcs
6089 3 056-02	LSA-Dummy plug 2/1, AÖ, green	100 pcs
6089 3 056-03	LSA-Dummy plug 2/1, AÖ, yellow	100 pcs
6089 3 056-04	LSA-Dummy plug 2/1, AÖ, green	100 pcs
6089 3 056-05	LSA-Dummy plug 2/1, AÖ, black	100 pcs
6089 3 056-06	LSA-Dummy plug 2/1, AÖ, brown	100 pcs
6089 3 056-07	LSA-Dummy plug 2/1, AÖ, blue	100 pcs

With extraction hook, for marking lines (1 pair) as well as preventing unwanted access to LSA-PLUS/PROFIL connection modules and to preventing disconnection in the case of disconnection modules

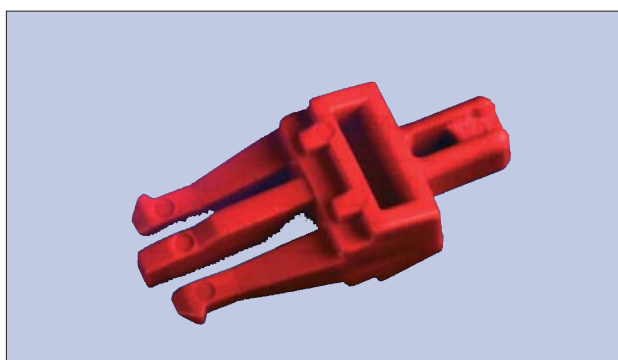

Order No.	Disconnection plug 2/1	Pack
6089 3 055-00	LSA-Disconnection plug 2/1, red	100 pcs
6089 3 055-01	LSA-Disconnection plug 2/1, white	100 pcs
6089 3 055-02	LSA-Disconnection plug 2/1, green	100 pcs
6089 3 055-03	LSA-Disconnection plug 2/1, yellow	100 pcs
6089 3 055-04	LSA-Disconnection plug 2/1, grey	100 pcs
6089 3 055-05	LSA-Disconnection plug 2/1, black	100 pcs
6089 3 055-06	LSA-Disconnection plug 2/1, brown	100 pcs
6089 3 055-07	LSA-Disconnection plug 2/1, blue	100 pcs

For opening of connections (1 pair) in LSA-PLUS/PROFIL disconnection modules.

